

## Heart of Oneness Holistic Expo 2025 NJ Convention & Exposition Center Edison, NJ

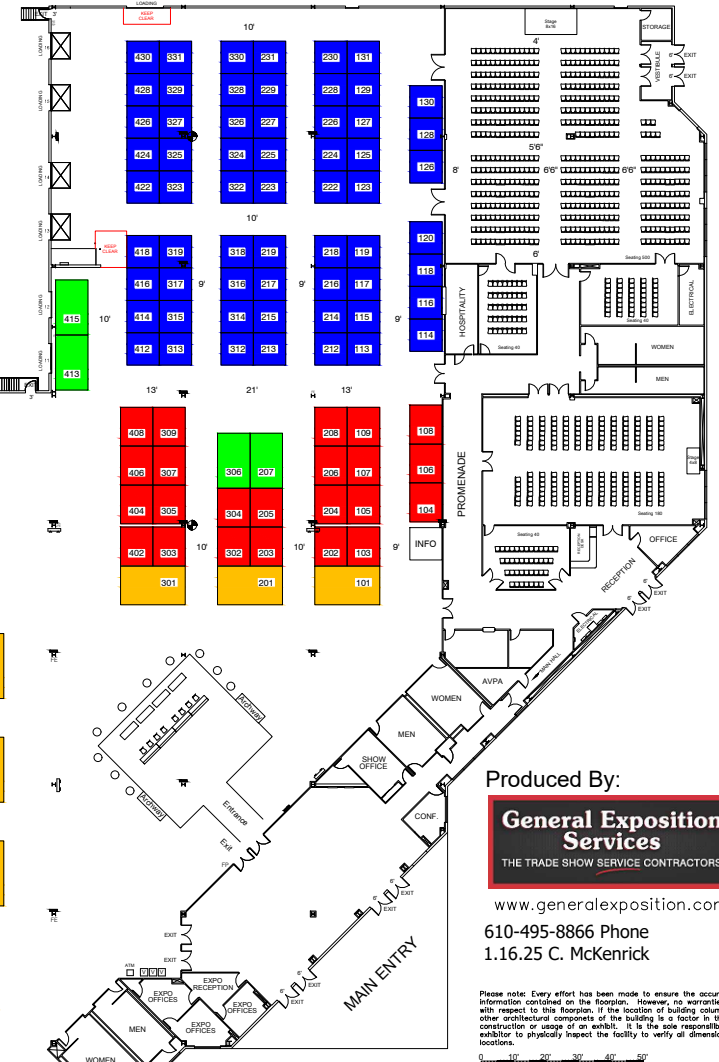

Produced By:  
**General Exposition Services**  
 THE TRADE SHOW SERVICE CONTRACTORS

[www.generalexposition.com](http://www.generalexposition.com)  
 610-495-8866 Phone  
 1.16.25 C. McKenrick

Please note: Every effort has been made to ensure the accuracy of all the information contained on this floorplan. However, no warranties are made with respect to this floorplan. If the location of building columns, utilities or other architectural components of the building is a factor in the construction or usage of an exhibit, it is the sole responsibility of the exhibitor to physically inspect the facility to verify all dimensions and locations.

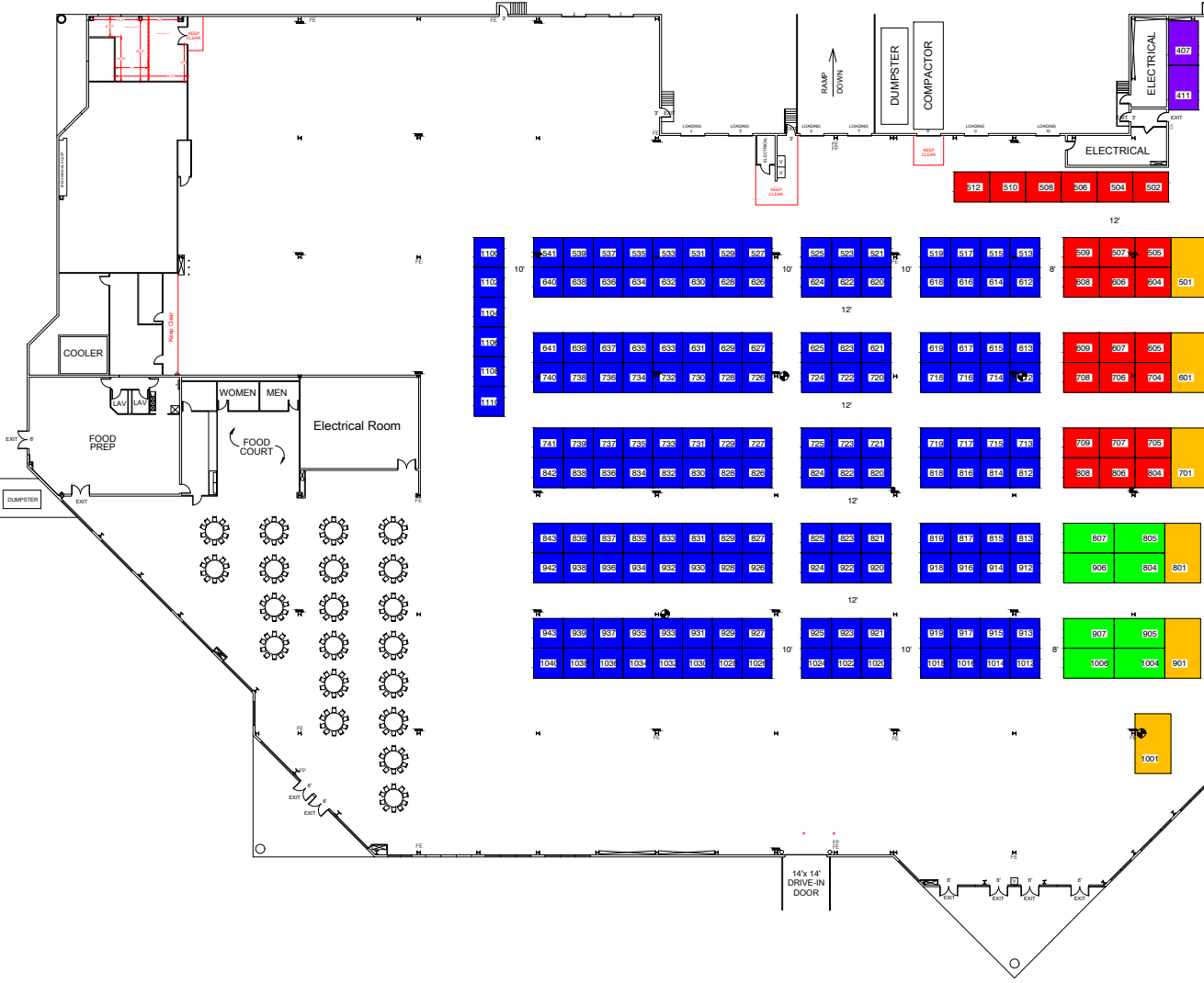
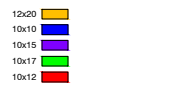

**Legend**

- 12x20
- 10x10
- 10x15
- 10x17
- 10x12
- Public Telephone
- Vending Machine
- Building Fixtures
- Alarm Pull Box
- Fire Extinguisher
- Electrical Box
- Water Supply
- Air Supply